

ON 12"X24"X24" CONC. FTG.

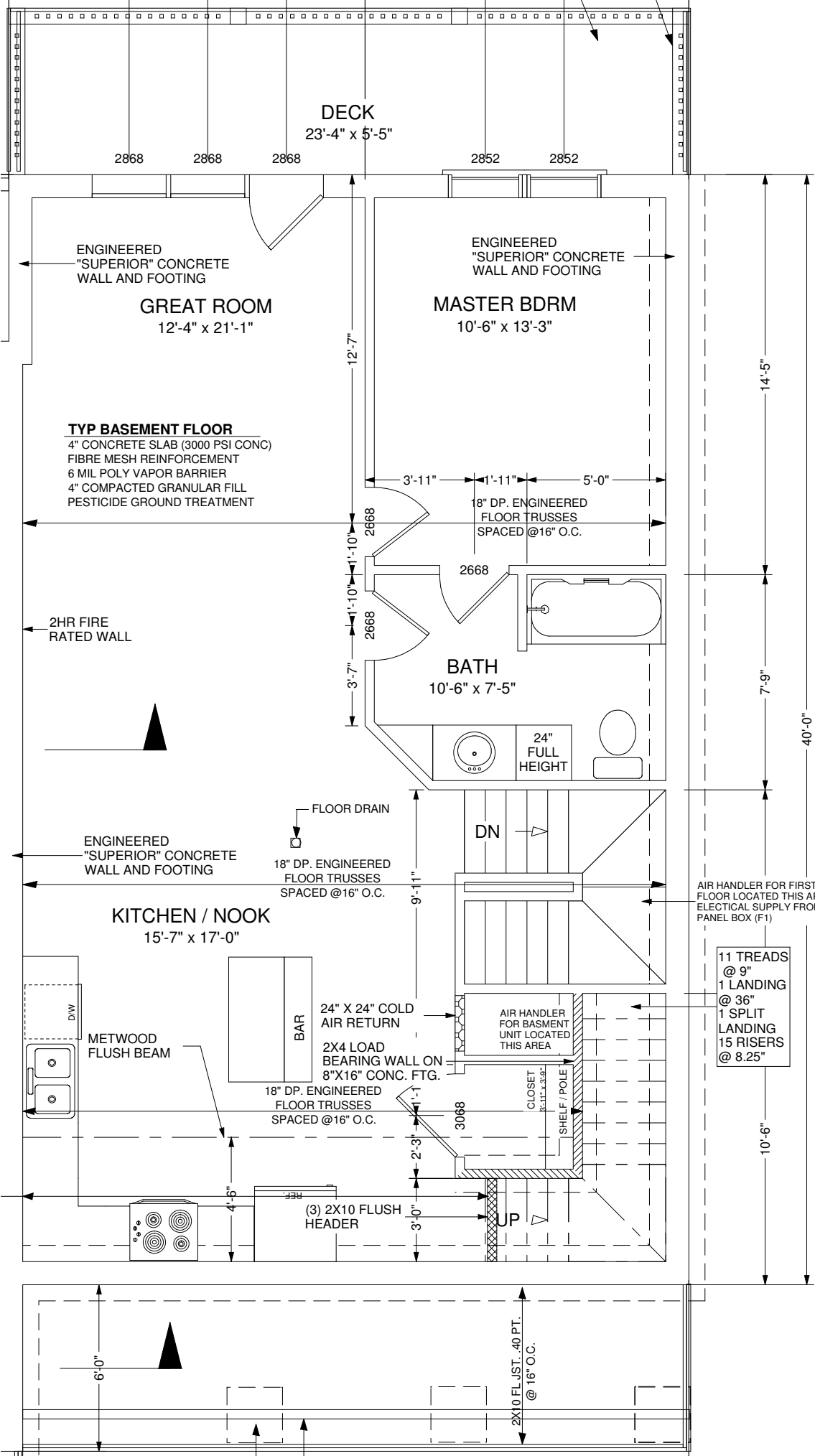

**DECK**  
23'-4" x 5'-5"

2868 2868 2868 2852 2852

ENGINEERED  
"SUPERIOR" CONCRETE  
WALL AND FOOTING

**GREAT ROOM**  
12'-4" x 21'-1"

ENGINEERED  
"SUPERIOR" CONCRETE  
WALL AND FOOTING

**MASTER BDRM**  
10'-6" x 13'-3"

**TYP BASEMENT FLOOR**  
4" CONCRETE SLAB (3000 PSI CONC)  
FIBRE MESH REINFORCEMENT  
6 MIL POLY VAPOR BARRIER  
4" COMPACTED GRANULAR FILL  
PESTICIDE GROUND TREATMENT

3'-11" 1'-11" 5'-0"  
18" DP. ENGINEERED  
FLOOR TRUSSES  
SPACED @16" O.C.

2HR FIRE  
RATED WALL

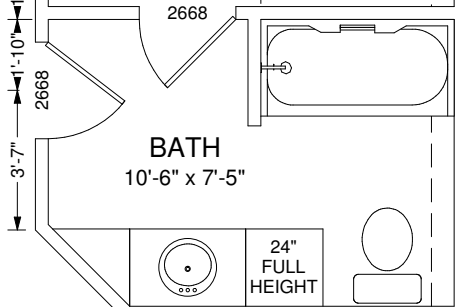

**BATH**  
10'-6" x 7'-5"

24"  
FULL  
HEIGHT

ENGINEERED  
"SUPERIOR" CONCRETE  
WALL AND FOOTING

FLOOR DRAIN  
18" DP. ENGINEERED  
FLOOR TRUSSES  
SPACED @16" O.C.

DN

AIR HANDLER FOR FIRST  
FLOOR LOCATED THIS AREA  
ELECTICAL SUPPLY FROM  
PANEL BOX (F1)

**KITCHEN / NOOK**  
15'-7" x 17'-0"

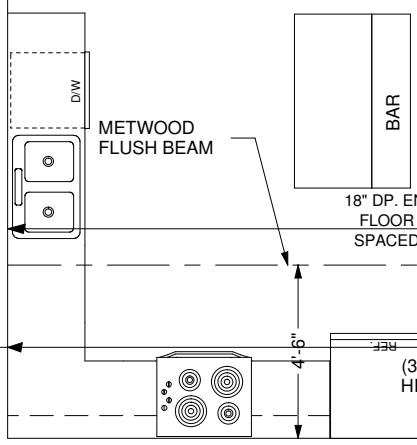

METWOOD  
FLUSH BEAM

24" X 24" COLD  
AIR RETURN  
2X4 LOAD  
BEARING WALL ON  
8"X16" CONC. FTG.  
18" DP. ENGINEERED  
FLOOR TRUSSES  
SPACED @16" O.C.

AIR HANDLER FOR  
BASMENT  
UNIT LOCATED  
THIS AREA

11 TREADS  
@ 9"  
1 LANDING  
@ 36"  
1 SPLIT  
LANDING  
15 RISERS  
@ 8.25"

CLOSET  
SHELF / POLE

(3) 2X10 FLUSH  
HEADER

10'-6"



2X10 FLUSH...40 PT.  
@ 16" O.C.

14'-5"

7'-9"

40'-0"